

EN

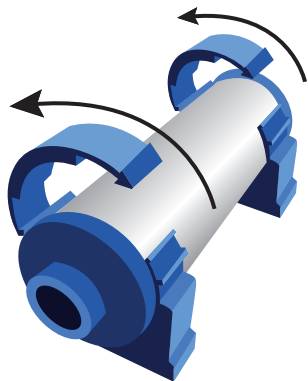

1. Open the brackets and get the filter out. You can use these to mount the InstantTrust Marine Inline to a wall or wooden plate.

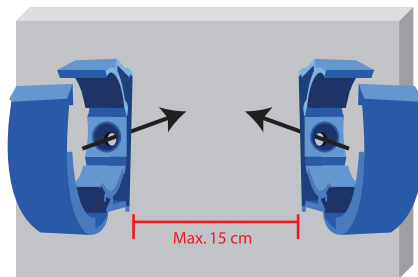

2. Mount the brackets to a wall or wooden plate. NOTICE: The distance between the bracket can only be 15 cm.

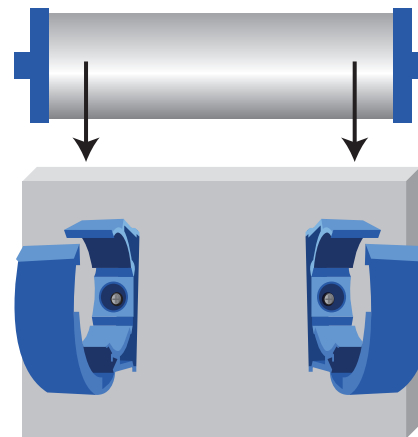

3. Place the filter back in the brackets.

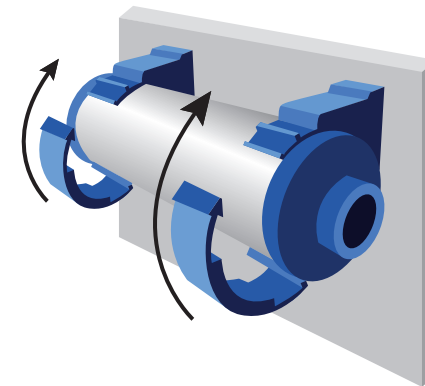

4. Close the brackets so the filter is secured.

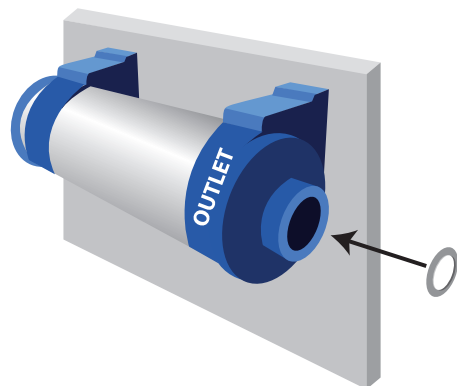

5. Check if there is a rubber ring in the opening of the outlet.

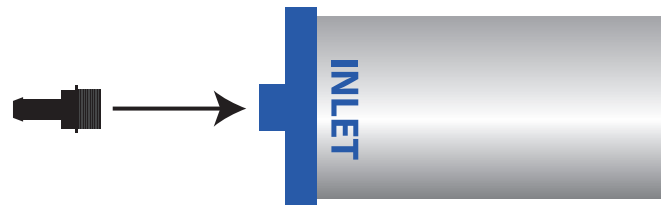

6. Turn the adapter on the inlet. Two different sizes are included (12 mm and 20 mm).



7. Turn the adapter with the rubber in it on the outlet. Two different sizes are included (12 mm and 20 mm).



NOTICE: Be sure to close the water supply!



8. Cut off the water hose.



9. Mount the hose to the adapters.

TIP:

Use hose clamps to make sure the water hose is tightened.

Make sure everything is secure. You can turn the water back on.

(CN)

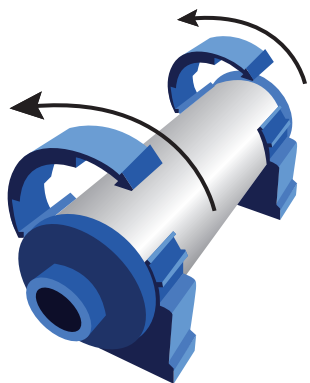

1, 打开托架, 将过滤器取出。

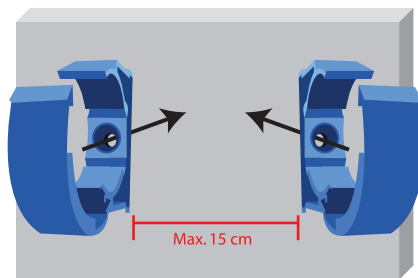

2, 将托架固定在墙面或木板上
注意: 托架内侧距离最大不能超过15cm

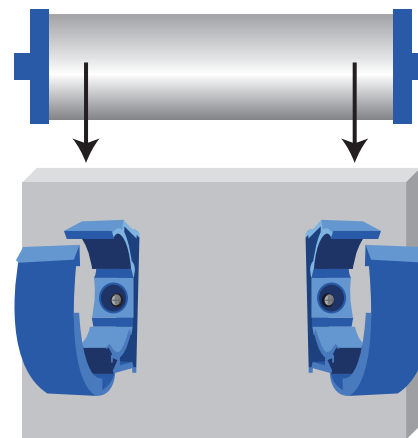

3, 将过滤器放回托架, 注意方向

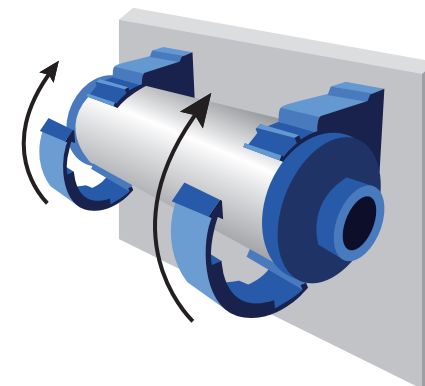

4, 将卡扣固定, 锁紧过滤器

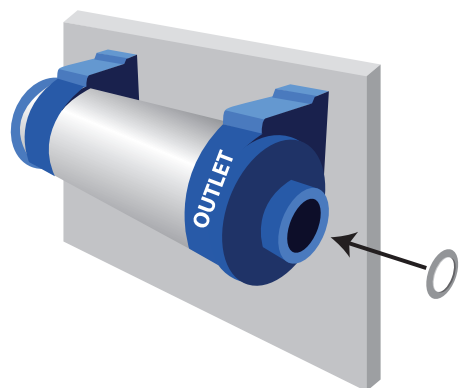

5, 检查出水口开口处是否有密封圈

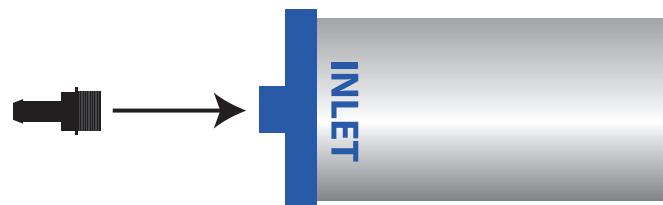

6, 将接头拧紧到过滤器进水口上。
有两种不同的接头 (12mm和20mm)

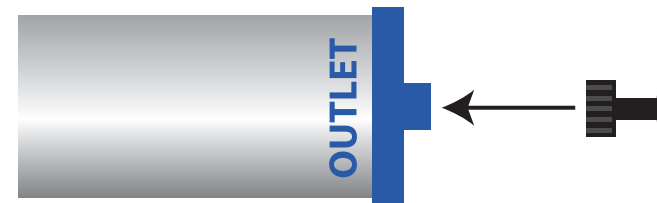

7, 将接头和密封圈拧紧到过滤器出水口上。有两种不同的接头 (12mm和20mm)

注意: 安装前先断水!



8, 量好尺寸, 切口水管, 准备安装



9, 将水管和过滤器连接

TIP:

使用管箍确保连接紧密, 无泄露

确保所有连接都是安全的之后。
将水阀打开